

EMAAR SOUTH

golf lane

EMAAR



A Community
of Graceful Living

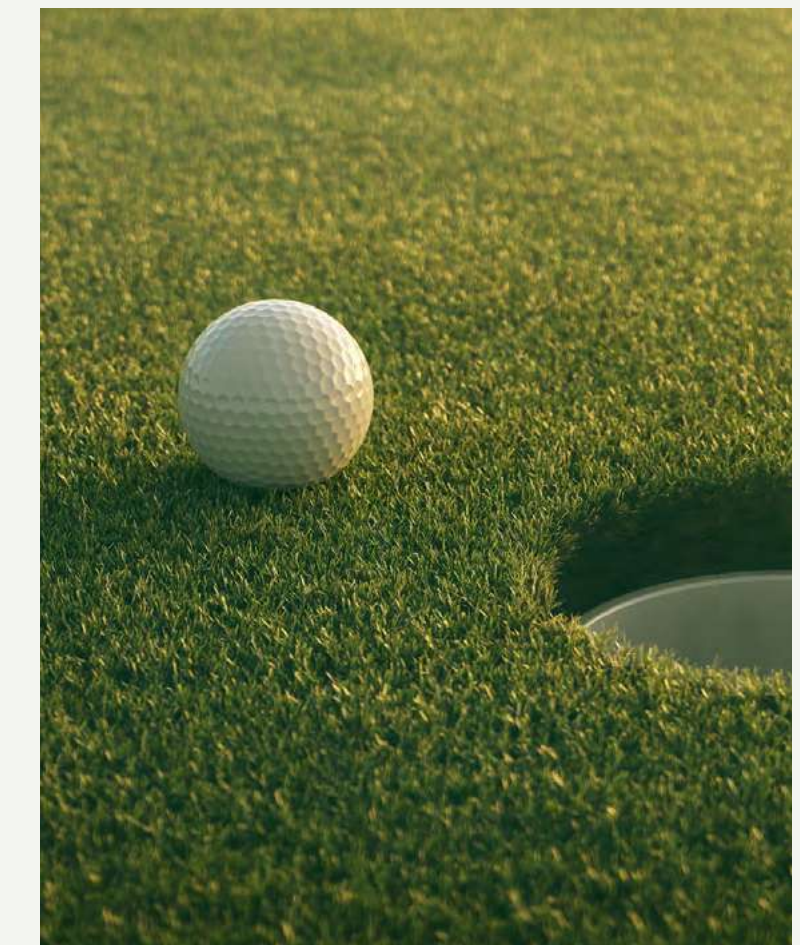
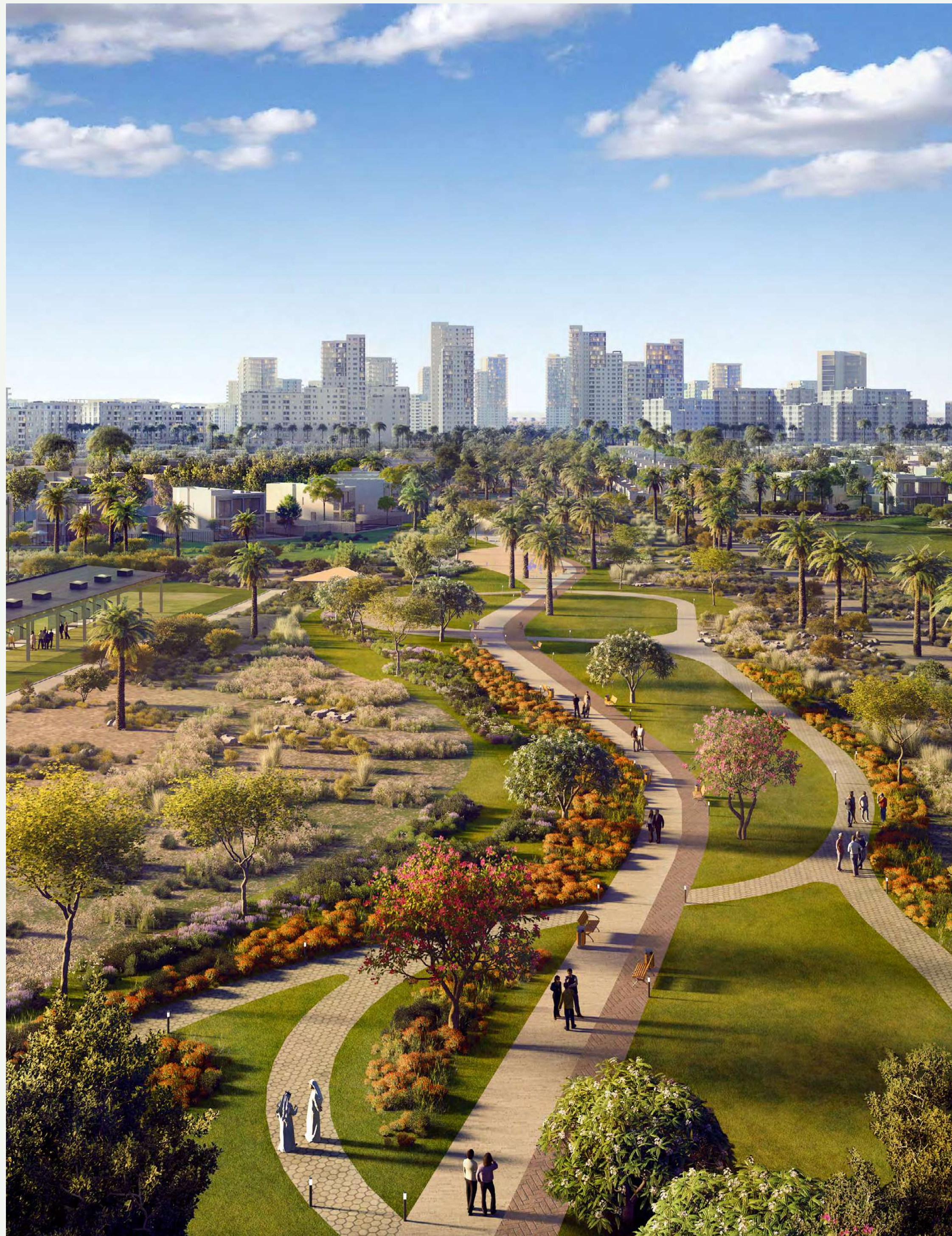

Emaar South

Embrace a new chapter in Dubai's dynamic landscape at Emaar South, a community where your visions are nurtured, and your ambitions take shape. This is where innovation meets everyday living, offering you a platform to excel and achieve. Discover the future of harmonious living at Emaar South - your gateway to a life of inspiration and achievement.



EMAAR SOUTH

JEBEL ALI
FREE ZONE

EMAAR
BEACHFRONT

PALM ISLAND

THE WORLD ISLAND

RASHID YACHTS
& MARINA

BURJ KHALIFA

DUBAI
MARINA

DOWNTOWN
DUBAI

DUBAI
FRAME

EMIRATES
LIVING

THE DUBAI MALL

DEIRA

DUBAI
INTERNATIONAL
AIRPORT

DUBAI
INVESTMENTS
PARK

DUBAI HILLS
ESTATE

AL MAKTOUM
INTERNATIONAL
AIRPORT

THE
OASIS
BY EMAAR

ARABIAN
RANCHES I

ARABIAN
RANCHES II

ARABIAN
RANCHES III

THE
HEIGHTS
COUNTRY CLUB &
WELLNESS

REEM

EMIRATES ROAD

*Convenience
Meets Serenity*



Perfectly Located

07 mins

Drive to
Al Maktoum Int'
Airport

10 mins

Drive to
Expo City Dubai

20 mins

Drive to
Dubai Marina

30 mins

Drive to
Downtown Dubai

50 mins

Drive to
Abu Dhabi





Local Community With A Global Gateway

Emaar South is perfectly positioned alongside Expo City Dubai, the future vision of the Expo 2020 Dubai site, offering easy access to Al Maktoum International Airport and a host of Dubai's most popular attractions and business hubs, via the adjacent boulevard and a major highway.



Linear 18-Hole
Golf Championship



Community
Park



Outstanding
Schools



Retail
Centre



Dining
Destinations



Community
Centre

A Place Where Beauty & Magic Collide



*Mastering the Art
of golf living*

Experience the captivating appeal of Golf Lane at Emaar South, where each of our villas is thoughtfully designed to effortlessly blend exquisite beauty with unmatched comfort. Indulge in a world where every intricate detail exudes splendour, and where each residence is a work of art, designed for those who long to embrace a life of breathtaking beauty.





Living the Green Dream

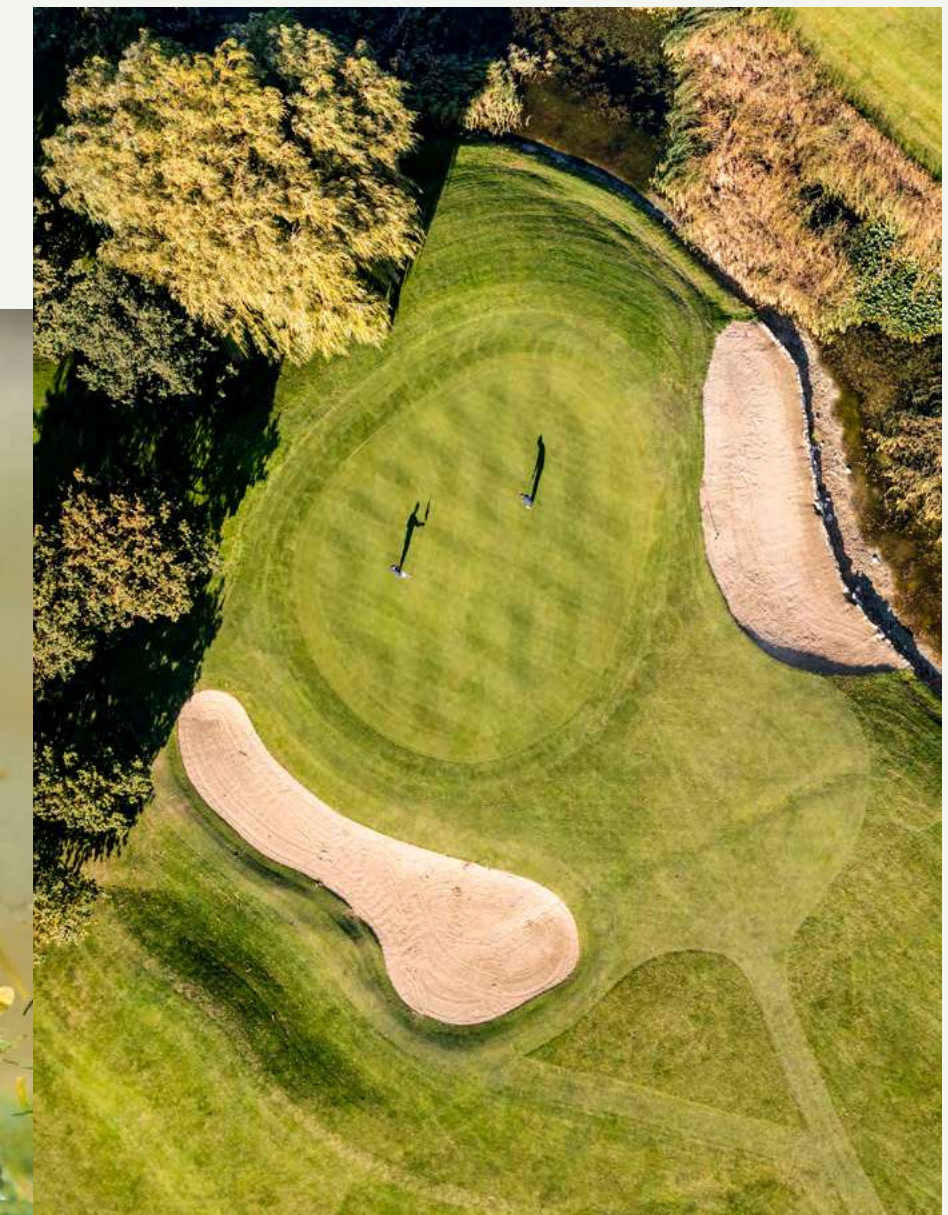

*Where the Best times
are tee times*

Picture a world where your home seamlessly blends with a breathtaking 18-hole golf course. The lush fairways invite you to come out and indulge in a game, while the clubhouse becomes your ultimate retreat for unwinding and enjoying yourself. Experience the enchantment of Golf Lane, where everyday life becomes a captivating masterpiece.

WELCOME TO

golf Lane

EMAAR SOUTH



Every Journey Begins at Home
**Where Every Corner
Is a Destination**

Perfectly positioned in the heart of Emaar South, Golf Lane provides a harmonious balance between peaceful suburban living and the lively energy of the city. With easy highway access, the city's hustle is within reach, yet far enough that you can retreat to your peaceful have whenever you desire.

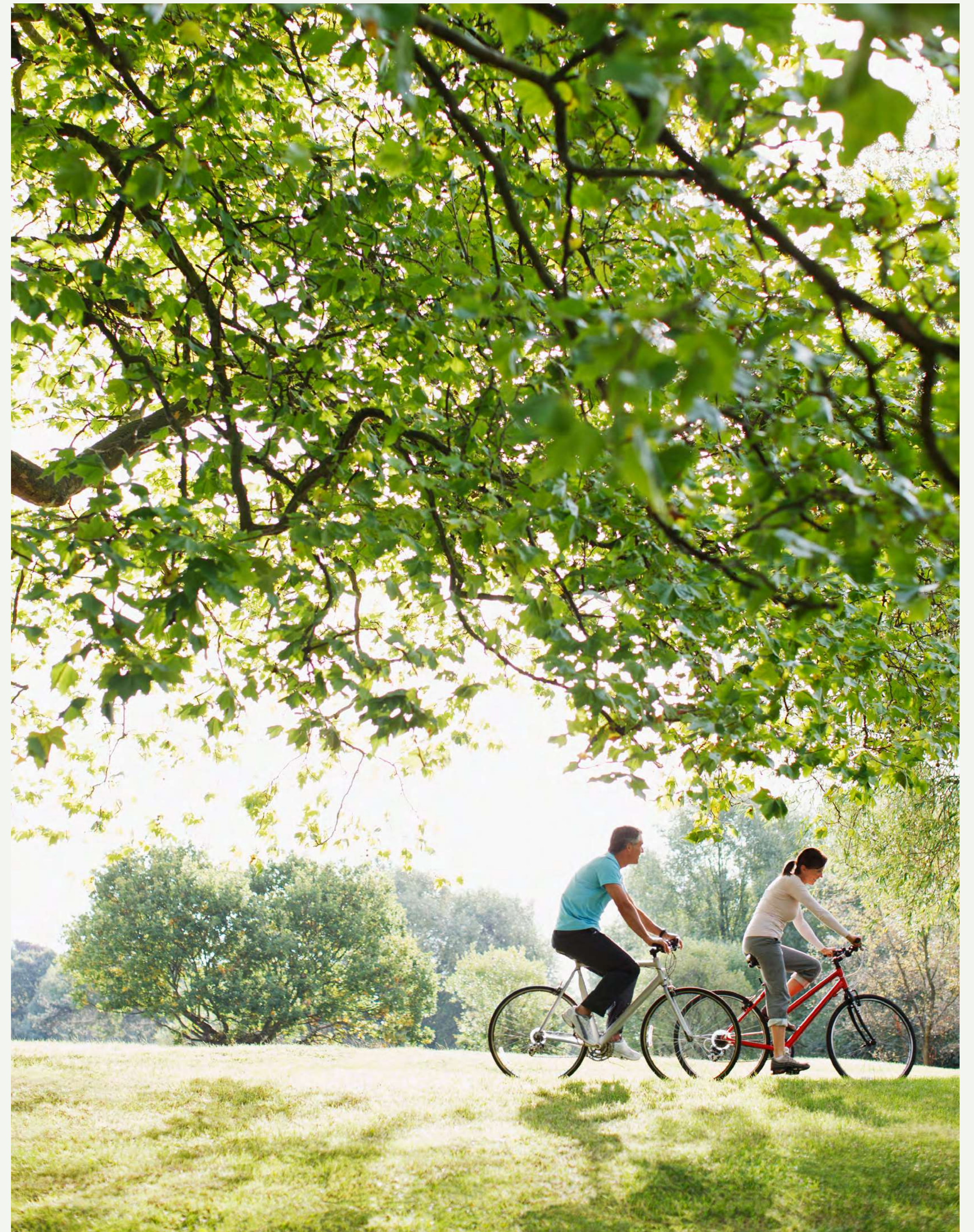



Al Maktoum International Airport

DWC PERIPHERAL ROAD

DWC PERIPHERAL ROAD

EMIRATES ROAD

golf lane
EMAAR SOUTH

- | | |
|------------------|------------------|
| 1 HOTEL | 6 MOSQUE |
| 2 GOLF COURSE | 7 NURSERY |
| 3 GOLF CLUBHOUSE | 8 K-12 SCHOOL |
| 4 RETAIL | 9 COMMUNITY PARK |
| 5 CLINIC | 10 DISTRICT PARK |





Inspired Architecture

Find Your Sanctuary of Style & Space

Each villa at Golf Lane is a piece of architectural brilliance, featuring sleek contemporary lines and a design that's as functional as it is beautiful. Generous private balconies and stylish patios bring you even closer to nature, while your private rooftop terrace offers unmatched views of the pristine fairways.





Your Choice of Sanctuary

Elegantly Designed, Naturally Inspired

Discover our exquisite collection of villas, offering two distinct styles that cater to your personal taste: the charming 4-bedroom semi-detached homes, and the expansive 5-bedroom standalone homes. Whichever you choose, expect a blend of luxury and comfort, designed to elevate your everyday.

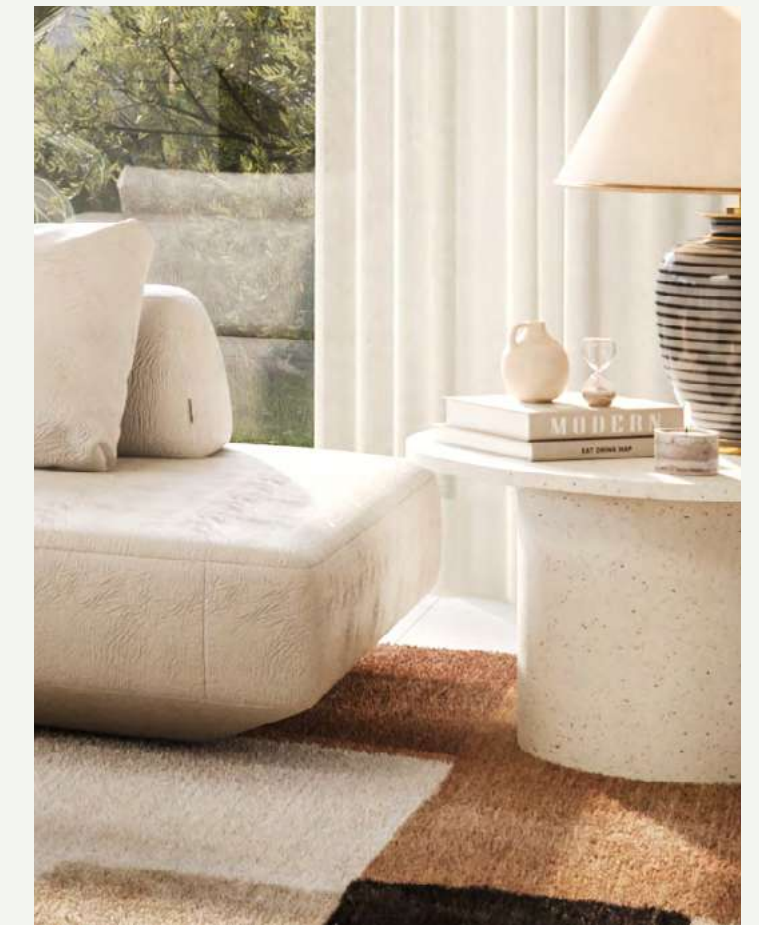

Interiors That Reflect the Great Outdoors
Elegance in Every Light

The interiors, bathed in warm, inviting tones, reflect the stunning beauty of the surrounding landscapes, turning every window into a living portrait, and seamlessly blending indoor elegance with outdoor splendour. Every room is transformed by the gentle play of natural light, creating a serene and harmonious living space that feels both expansive and intimate.





*Enriching Every Day
with Premier Amenities*

Amenities to Adore

Beyond the fairways, Golf Lane is a full-fledged lifestyle hub. From a modern gym that motivates you to push your limits, to pools that invite you to unwind and play areas where children can laugh and explore—life here is about enriching every moment.



18-Hole Championship
Golf Course



Community Park



Community Centre



Clubhouse



Outdoor Communal
Areas



Swimming Pool
& Kids' Play Area



Fully Equipped
Gym



Linear Park



Multi-purpose
room



Jogging Path



Community Park

This sustainably designed community park offers beautifully landscaped spaces for various recreational activities.

Kids' Play Areas

Retail Plaza & Kiosks

Skate Park & Multi-Purpose Court

Events Area



Golf Course

Perfect your game at the 18-hole championship golf course

Pristine Fairways

Immaculately Manicured Greens

Clubhouse

World-class Facilities

Dining Experiences



Kids' Play Areas

Enjoy fun, games and quality time with your little ones.

Ideal for Children of All Ages

Fully equipped gym

Multi-Purpose Activity Areas

Exceptional Facilities





Minutes away from Al Maktoum International Airport

Al Maktoum International Airport is a global hub in the making. Located a mere 8-hours' flight time away from two-thirds of the world's population, it will greatly benefit from Dubai's hassle-free visa system.

- Passenger Capacity of 220m per Year
- Executive Jet Terminal
- Cargo Capacity of 16m tonnes per Year
- Air-Sea Connectivity Achievable in 4 hours



Global Lifestyle Developer

EMAAR

A leader in the global real estate market, EMAAR has grown over the years to become the largest real estate developer outside of China. You will be investing with one of the best-regarded brands in the world*.

AED 70.09 Bn

Market Cap - FY 2023

AED 26.7 Bn

Revenue - FY 2023

AED 11.6 Bn

Net Profit - FY 2023

108,000

Residential Units Delivered

+12

Global Market Presence

+25,500

Residential Units Currently Under Development

*As on 31 December 2023

golf Lane

For more information please call 800 36227 (UAE) / +971 4 366 1688 (International) or talk to our Property Advisor directly at +971 4888 8844 from 9 AM to 7 PM (GST), Monday to Friday. Visit our online sales centre at emaar.com or any of our Sales Centres across the UAE.

DUBAI

Emaar Sales Centre | Next to Souq Al Bahar, Downtown Dubai
9:30 AM to 10 PM, Sunday - Friday
9:30 AM to 7 PM, Saturday

Dubai Hills Estate Sales Pavilion | Umm Suqeim Road
Dubai Creek Harbour Sales Pavilion | Ras Al Khor
From 9:30 AM to 7 PM, Sunday - Saturday

ABU DHABI

Emaar Sales Centre | Al Nahda Tower, Ground Floor,
4th Street, Corniche, Al Muroor Road
From 9:30 AM to 7 PM, Sunday - Friday

EMAAR