

lavita

THE OASIS



THE OASIS

BY EMAAR

Situated in the vibrant heart of Dubai, The Oasis by Emaar spans an impressive 100 million square feet, a testament to a vision of luxury that is both grand and thoughtful. Home to over 7,000 exquisitely designed residences, each framing serene views of meandering canals and lush green spaces, The Oasis is created to enhance the art of living.

The Art of Gracious Living

In the heart of The Oasis, Lavita offers a collection of 43 masterfully crafted mansions. Surrounded by the serene flow of waterways and the lush embrace of greenery, Lavita is a place where every detail is designed to calm the senses and elevate the spirit.



Your Private Haven

Lavita is a place where privacy meets connection, providing a peaceful retreat just moments from Dubai's premier attractions. Whether you're enjoying a round of golf, exploring luxury boutiques, or experiencing the cultural richness of Downtown Dubai, Lavita ensures you're at the heart of it all, with a serene sanctuary to return to.



Sophistication Etched in Every Line

Lavita's architecture embodies timeless elegance. Each mansion blends modern design with classic sophistication, creating homes that are as enduring as they are beautiful. Carefully selected materials enhance both aesthetics and sustainability, making each residence a lasting haven of luxury.

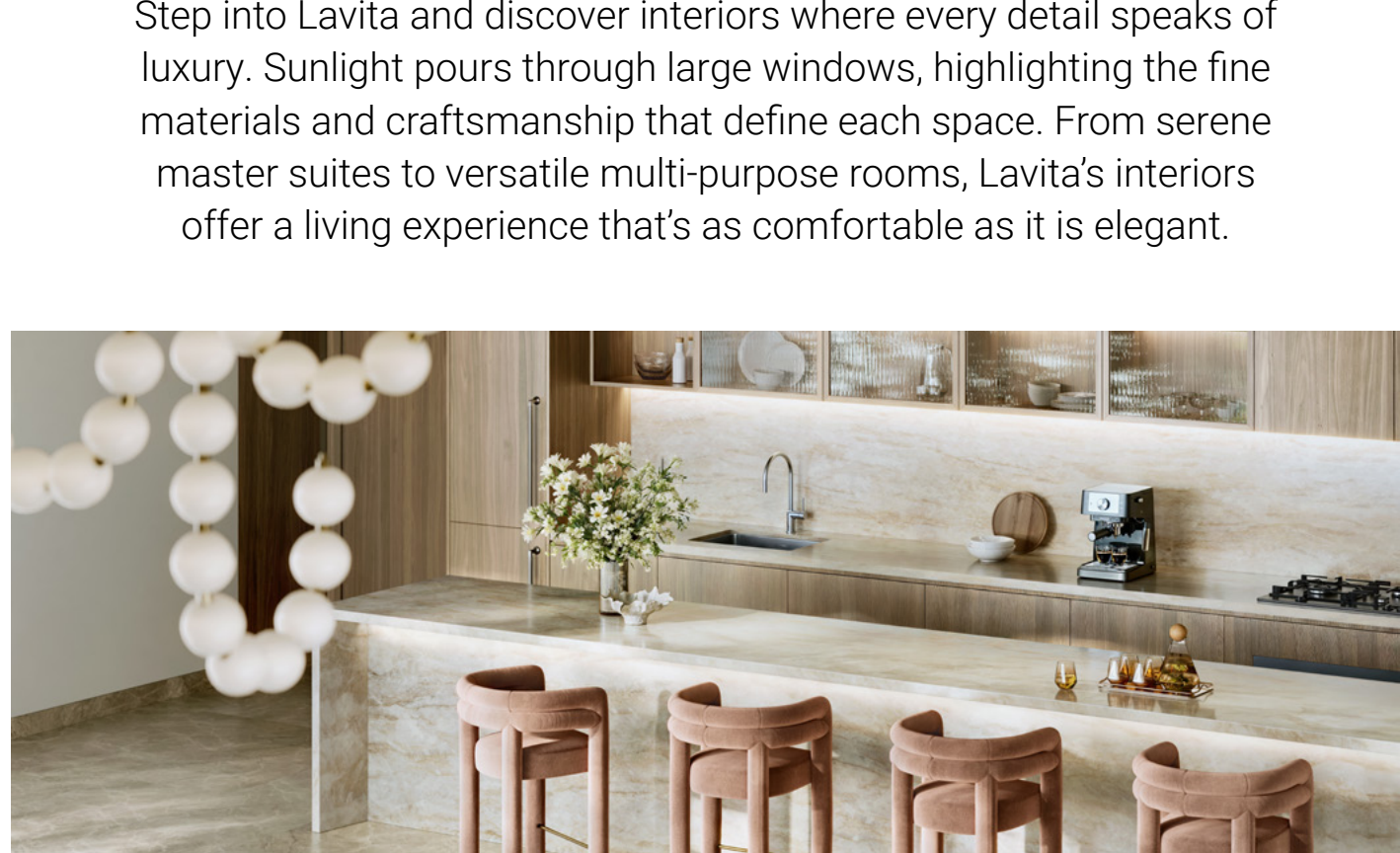

Refined Sophistication

Step into Lavita and discover interiors where every detail speaks of luxury. Sunlight pours through large windows, highlighting the fine materials and craftsmanship that define each space. From serene master suites to versatile multi-purpose rooms, Lavita's interiors offer a living experience that's as comfortable as it is elegant.

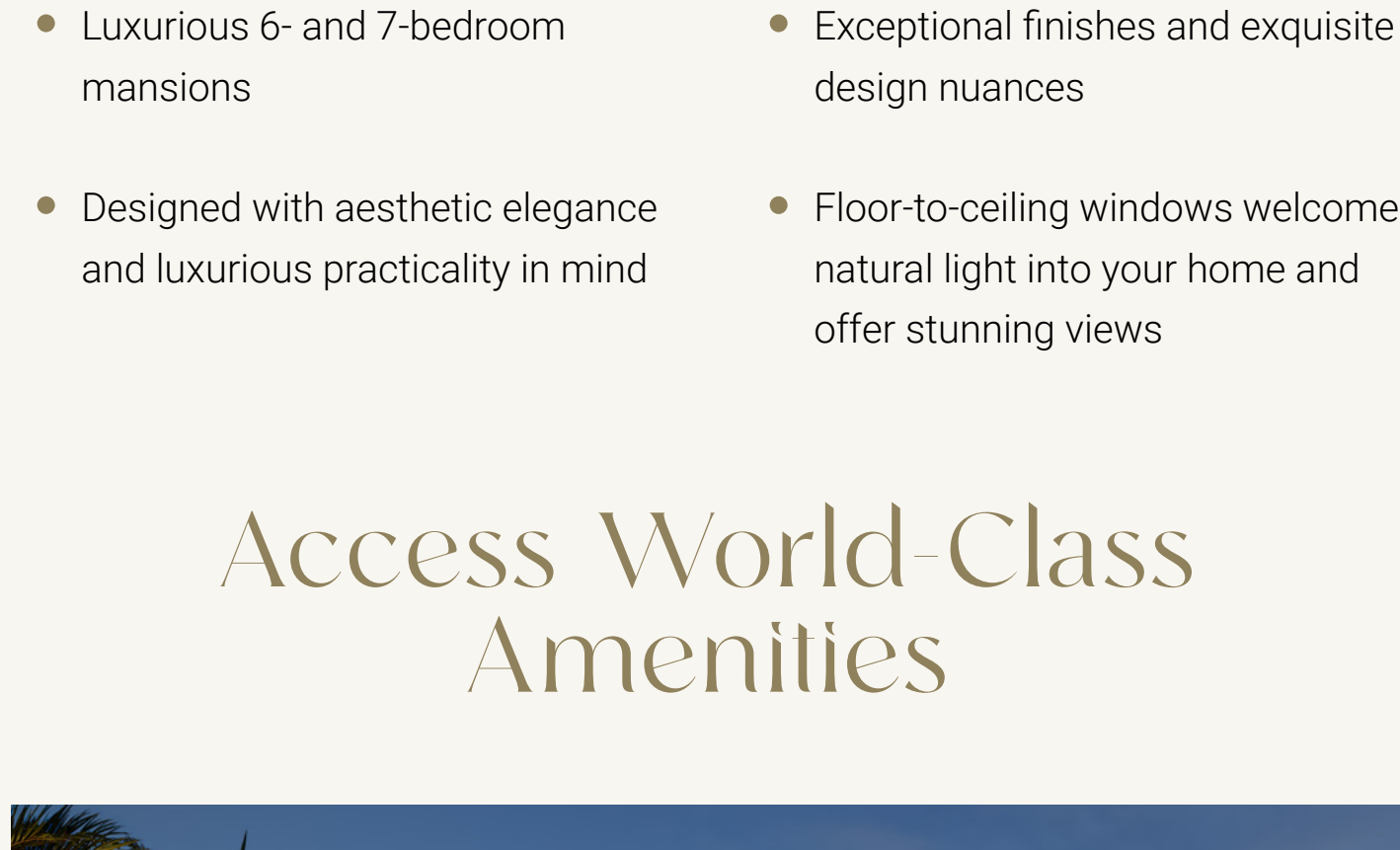

Residential Units

Mansion Types	Units	Avg. Area (sq. ft.)	Starting Price (in AED Mn)
6 Bedroom	26	19,099	36.61 Mn
7 Bedroom	17	28,039	54.77 Mn
Overall	43	22,634	36.61 Mn

- Luxurious 6- and 7-bedroom mansions
- Designed with aesthetic elegance and luxurious practicality in mind
- Exceptional finishes and exquisite design nuances
- Floor-to-ceiling windows welcome natural light into your home and offer stunning views

Access World-Class Amenities



Payment Plan

Instalment	Payment Percentage	Date
Down Payment	20%	Sep 2024
1st Instalment	10%	Apr 2025
2nd Instalment	10%	Sep 2025
3rd Instalment	10%	Feb 2026
4th Instalment 50% Construction Completion	10%	Sep 2026
5th Instalment 70% Construction Completion	10%	Mar 2027
6th Instalment 90% Construction Completion	10%	Oct 2027
7th Instalment 100% Construction Completion	20%	Dec 2028

Floor Plan

Typical 7 bedroom - Mansion Floor Plan



Basement



Ground Floor

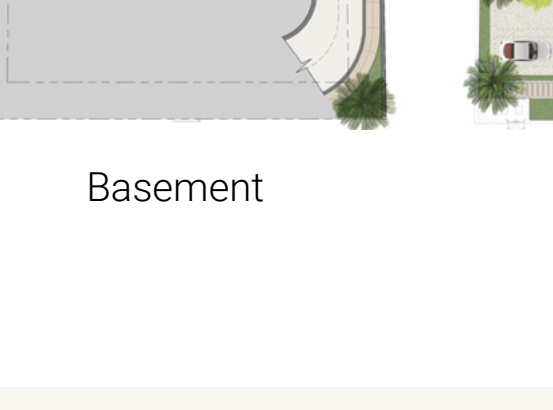

First Floor

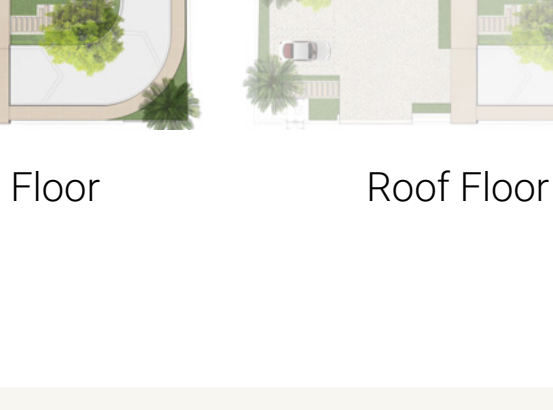

Roof Floor

Typical 6 bedroom - Mansion Floor Plan

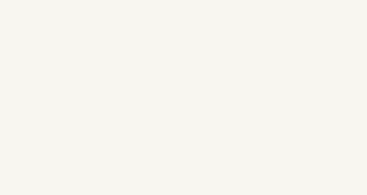

Basement



Ground Floor

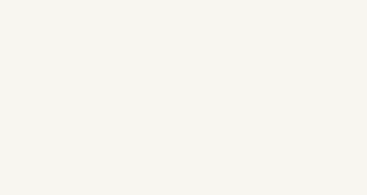

Roof Floor

Springfield

Properties

 +971 4 454 2588

info@springfield-re.com

springfieldproperties.ae